

SCOTCH-YOKE / DOUBLE ACTING / AD210

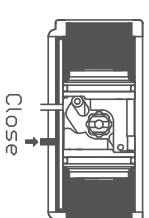

MAJOR PART LIST

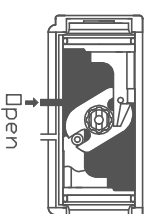
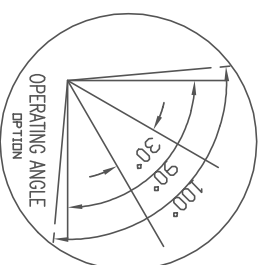
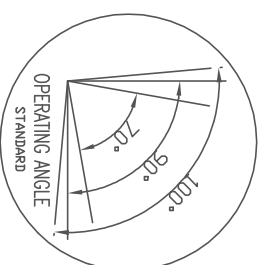
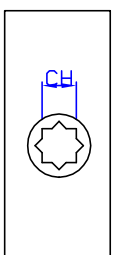
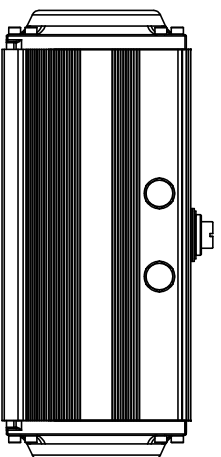
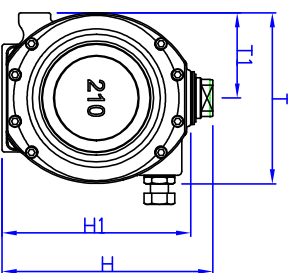
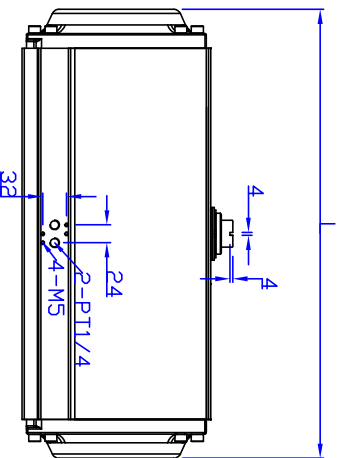
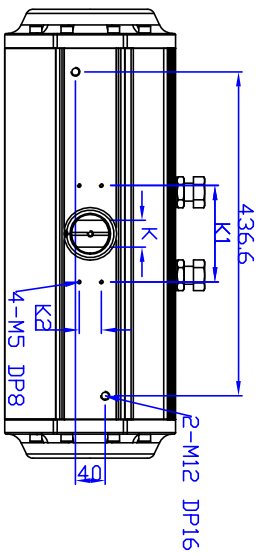
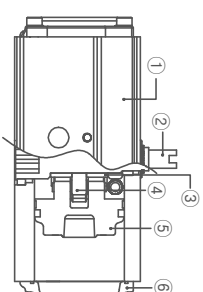

NO.	PART NAME	MATERIAL
1	BODY	ALUMINUM
2	SHAFT	STEEL ALLOY (NICKEL COATING)
3	SHAFT ROLLER	ENGINEERING PLASTIC
4	CRANK	STEEL ALLOY
5	PISTON	ALUMINUM
6	COVER	ALUMINUM

SPECIFICATIONS

1. Operating fluid : Compressed dry air
2. Operating pressure : 4Bar~7Bar
3. Operating temperature : -20~80°

■ DIMENSION(mm)

MODEL	K1	K2	ISO	ØP.C.D	N-G(DP)	K	L	T	T1	H	H1	CH	DP	WEIGHT
AD210	130	30	F16	165	4-M20 (30)	36	605	231	115	284	254	46*46	60	45.5kg

■ Torque (Nm) at 6bar

	0°	45°	90°
Open	3819.7	2399.8	3449.8
Close	3919.7	2299.8	3349.8

PRODUCT NAME		TITLE	
Pneumatic actuator		DRAWING	
MODEL	AD210	DRAWING NO.	PAAD210-001
MATERIAL	-	HARDNESS	-
DRAWING DATE	-	APPROVED DATE	-
KOSAPLUS Co.,Ltd		REV.	4

REV.NO.	REVISION DESCRIPTION	DRAWN / DATE	REVIEWED / DATE	APPROVED / DATE
△	무게정정 47.2 -> 45.5	노윤아 / 120607		
△	바닥 ISO 탭 길이재수 추가	노윤아 / 120727		

Operating

Open

Close