

RACK&PINION / SPRING RETURN / RS90

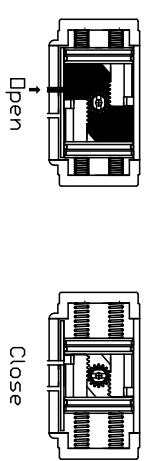
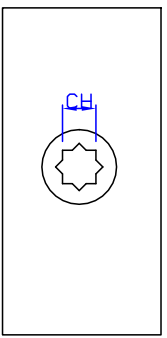
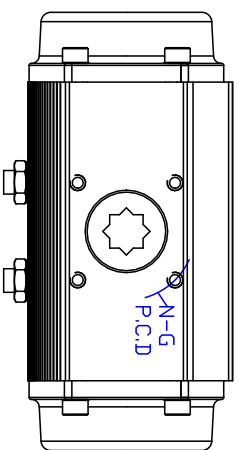
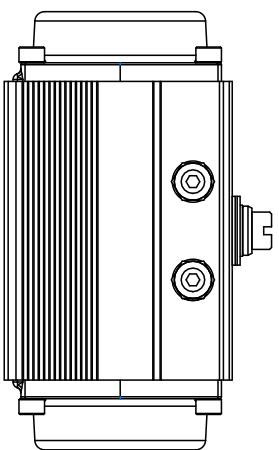
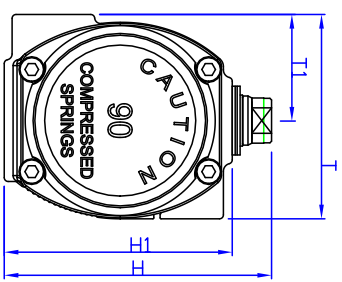
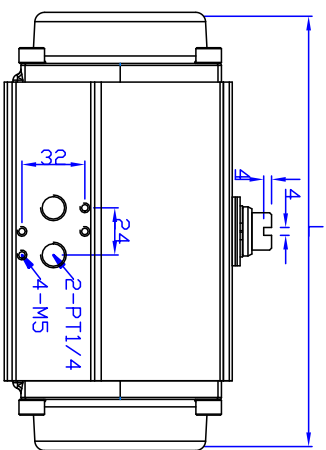
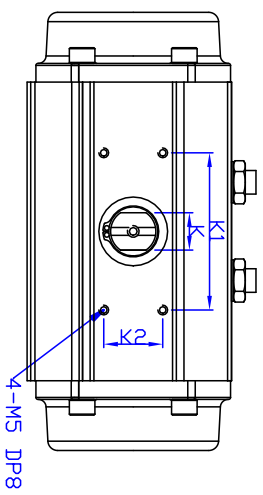

MAJOR PART LIST

NO.	PART NAME	MATERIAL
1	BODY	ALUMINIUM
2	SHAFT	STEEL ALLOY (NICKEL COATING)
3	PISTON	ALUMINIUM
4	COVER	ALUMINIUM

SPECIFICATIONS

1. Operating fluid : Compressed dry air
2. Operating pressure : 4Bar~7Bar
3. Operating temperature : -20~80°

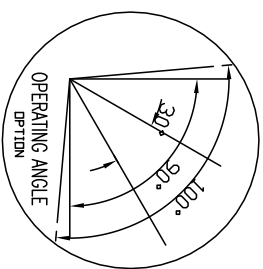
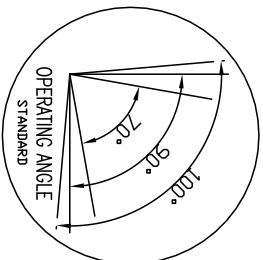

■ DIMENSION(mm)

MODEL	K1	K2	ISO	ØP.C.D	N-G(DP)	K	L	T	T1	H	H1	CH	DP	WEIGHT
RS90	80	30	F07	70	4-M8 (17)	19	223	104	54.5	136	116	17*17	19	3.8kg

■ Torque (Nm) at 4.5bar

	0°	90°
Open	56.2	36.5
Close (spring 8)	30.6	48.3

PRODUCT NAME Pneumatic actuator		TITLE DRAWING	
MODEL RS90	HARDNESS -	DRAWING NO. PARS90-001	REV. 4
MATERIAL -		DRAWING DATE	
DATE		APPROVED DATE	

KOSAPLUS Co.,Ltd