

SCOTCH-YOKE / DOUBLE ACTING / AD65

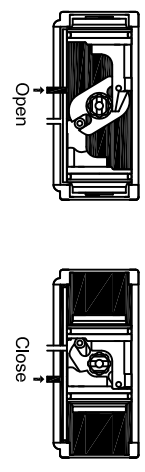
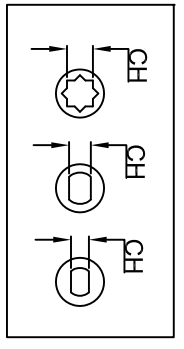
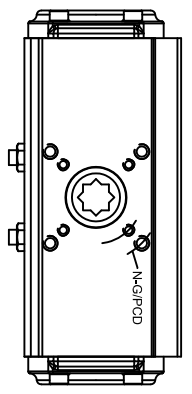
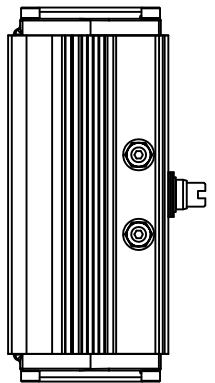
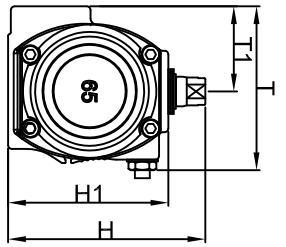
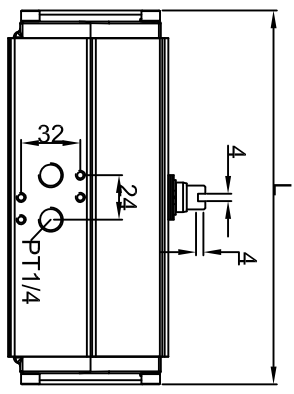
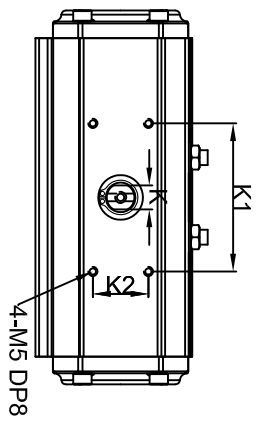

MAJOR PART LIST

NO.	PART NAME	MATERIAL
1	BODY	ALUMINUM
2	SHAFT	STEEL ALLOY (NICKEL COATING)
3	SHAFT ROLLER	ENGINEERING PLASTIC
4	CRANK	STEEL ALLOY
5	PISTON	ALUMINUM
6	COVER	ALUMINUM

SPECIFICATIONS

1. Operating fluid : Compressed dry air
2. Operating pressure : 4Bar~7Bar
3. Operating temperature : -20°~80°

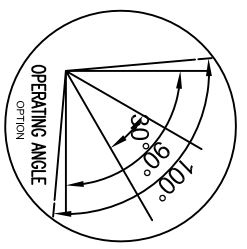
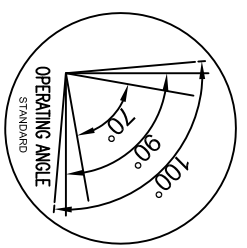

■ DIMENSION(mm)

MODEL	K1	K2	ISO	ØP.C.D	N-G (DP)	K	L	T	T1	H	H1	CH	DP	WEIGHT
AD65	80	30	F05/F07	50/70	4-M6/M8 (14/14)	13	202	89	46	107	87	14*14	17	2.3kg

■ Torque (Nm) at 4.5bar

	0°	45°	90°
Open	86.5	56.0	82.0
Close	95.0	51.0	80.0

PRODUCT NAME
Pneumatic actuator

MODEL
AD65

TITLE
DRAWING

KOSAPLUS Co.,Ltd

DRAWING NO.	REV.
PAAD65-001	6