

SCOTCH-YOKE / DOUBLE ACTING / AD50

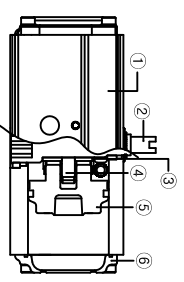
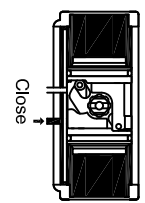
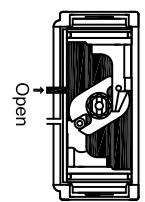
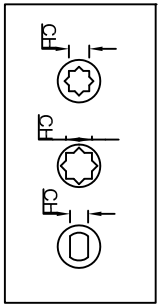
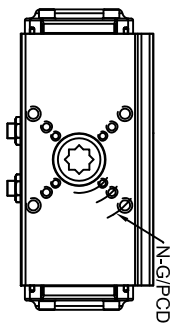
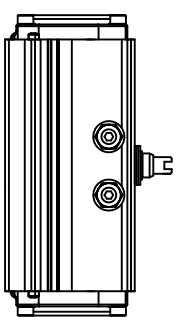
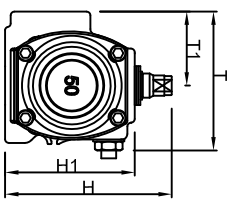
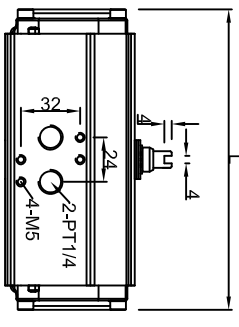
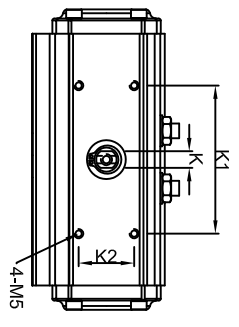

NO.	PART NAME	MATERIAL
1	BODY	ALUMINUM
2	SHAFT	STEEL ALLOY (NICKEL COATING)
3	SHAFT ROLLER	ENGINEERING PLASTIC
4	CRANK	STEEL ALLOY
5	PISTON	ALUMINUM
6	COVER	ALUMINUM

SPECIFICATIONS

1. Operating fluid : Compressed dry air
2. Operating pressure : 4Bar~7Bar
3. Operating temperature : -20~-80

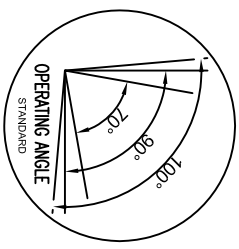

DIMENSION(mm)														
MODEL	K1	K2	ISO	ØP.C.D	N-G (DP)	K	L	T	T1	H	H1	CH	DP	WEIGHT
AD50	80	30	F03/F05/F07	35/50/70	4-M5/M6/M8 (10/12/12.5)	9	162	75	40	90	70	11*11	13	1.4kg
												14*14	14	
												9.7*Ø15	14	

PRODUCT NAME Pneumatic actuator		TITLE DRAWING	
MODEL AD50	HARDNESS -	DRAWING NO. PAAD50-001	REV. 7
MATERIAL -		APPROVED DATE	
DATE		DATE	

REV.NO.	REVISION DESCRIPTION	DRAWN / DATE	REVIEWED / DATE	APPROVED / DATE
△	도기삭제 및 정렬	노용아 / 170703		
△	커버 용량 설계변경	노용아 / 191115		

MAJOR PART LIST

OPERATING