

# SCOTCH-YOKE / DOUBLE ACTING / AD100

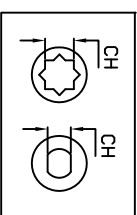

REV.NO.	REVISION DESCRIPTION	DRAWN / DATE	REVIEWED / DATE	APPROVED / DATE
△	바닥 ISO 열 김이러수 수거	노용아 / 120727		
△	바닥 ISO 열 김이러수 수경	노용아 / 130619		

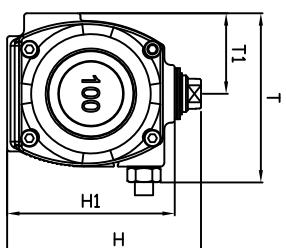
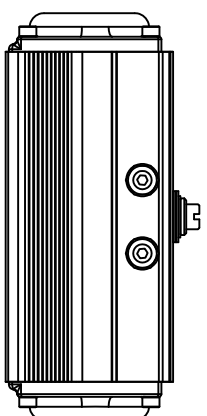
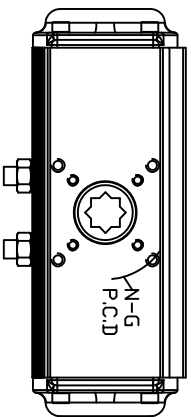
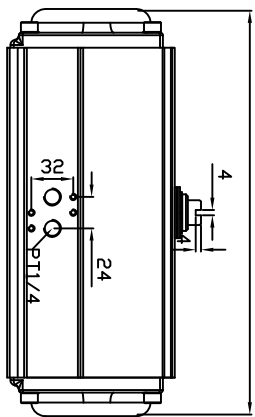
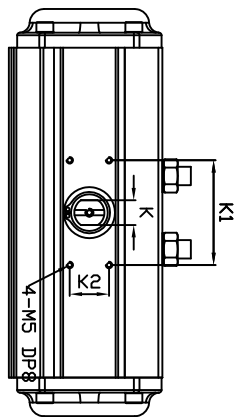
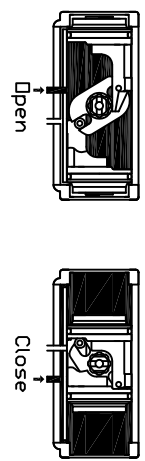

### MAJOR PART LIST

NO.	PART NAME	MATERIAL
1	BODY	ALUMINUM
2	SHAFT	STEEL ALLOY (NICKEL COATING)
3	SHAFT ROLLER	ENGINEERING PLASTIC
4	GRANK	STEEL ALLOY
5	PISTON	ALUMINUM
6	COVER	ALUMINUM

### SPECIFICATIONS

1. Operating fluid : Compressed dry air
2. Operating pressure : 4Bar~7Bar
3. Operating temperature : -20~80°

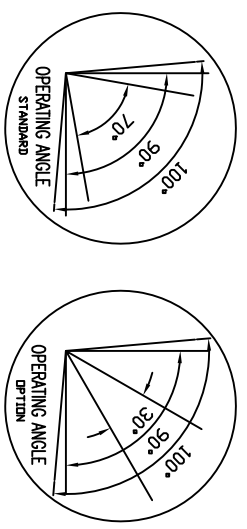

DIMENSION(mm)												
MODEL	K1	K2	ISO	φP.C.D	N-G(OP)	K	L	T	T1	H	H1	CH
AD100	80	30	F07/F10	70/102	4-MB/M10 (16/21)	19	311	129	61.5	148	128	22*22
												DP
												17.7*φ22
												27
												WEIGHT
												Open
												26
												Close
												27
												6.7kg

Torque (Nm) at 4.5bar			
0°	45°	90°	
269.5	180.5	269.0	
296.5	166.0	264.0	

PRODUCT NAME Pneumatic actuator		MODEL AD100		TITLE DRAWING	
DRAWING DATE		APPROVED DATE		DRAWING NO. PAAD100-001	
				REV. 5	

KOSAPLUS Co.,Ltd