

# RACK&PINION / DOUBLE ACTING / RD90

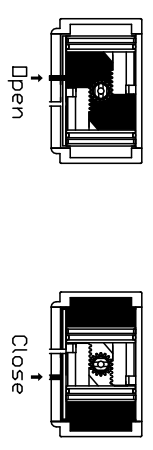
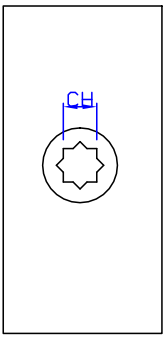
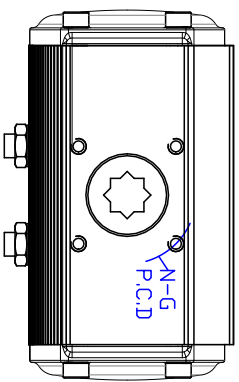
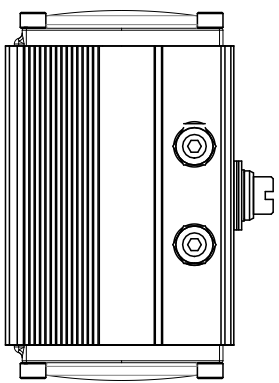
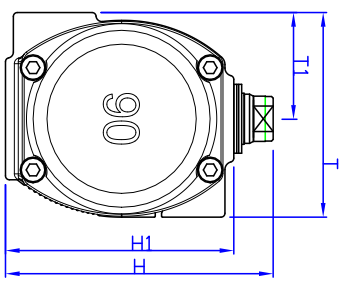
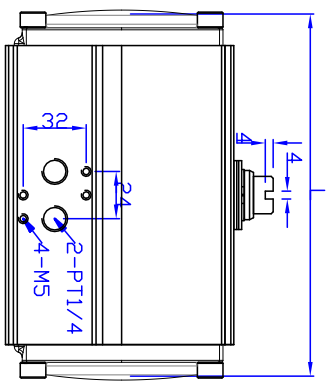
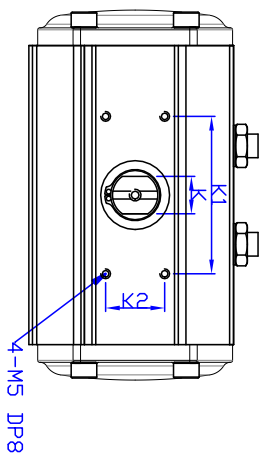

### MAJOR PART LIST

NO.	PART NAME	MATERIAL
1	BODY	ALUMINUM
2	SHAFT	STEEL ALLOY (NICKEL COATING)
3	PISTON	ALUMINUM
4	COVER	ALUMINUM

### SPECIFICATIONS

1. Operating fluid : Compressed dry air
2. Operating pressure : 4Bar~7Bar
3. Operating temperature : -20~80°

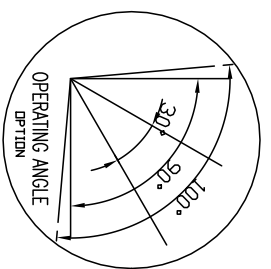
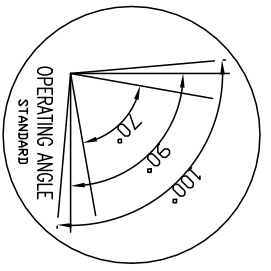

### ■ DIMENSION(mm)

MODEL	K1	K2	ISO	ØP.C.D	N-G(DP)	K	L	T	T1	H	H1	CH	DP	WEIGHT
RD90	80	30	F07	70	4-M8 (17)	19	188	104	54.5	136	116	17*17	19	3.4kg

### ■ Torque (Nm) at 4.5bar

	Open	Close
Torque (Nm)	86.8	86.8

<b>PRODUCT NAME</b> Pneumatic actuator		<b>TITLE</b> DRAWING	
<b>MODEL</b> RD90	<b>HARDNESS</b> -	<b>DRAWING NO.</b> PARD90-001	<b>REV.</b> 3
<b>MATERIAL</b> -	<b>APPROVED DATE</b> -	<b>DRAWING NO.</b> PARD90-001	
<b>DATE</b> -		<b>REV.</b> 3	

**KOSAPLUS Co.,Ltd**

REV.NO.	REVISION DESCRIPTION	DRAWN / DATE	REVIEWED / DATE	APPROVED / DATE
△	바닥 ISO 및 길이수 삽입	노윤아 / 120730		
△	내지수, 하부 체결구 수정	노윤아 / 130619		