

SCOTCH-YOKE / AD250

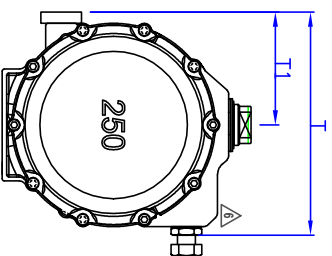

40
4-M6
2-PT3/8 DR 1/2
45 OPTION; 3/8 DR 1/2

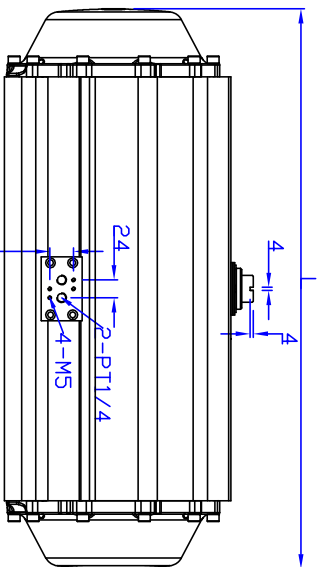
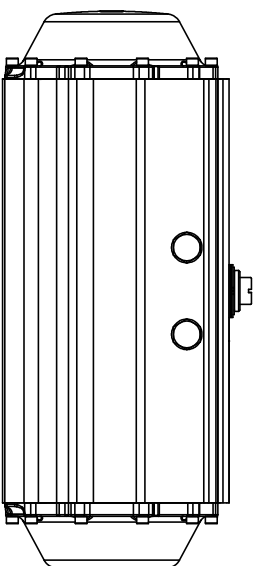
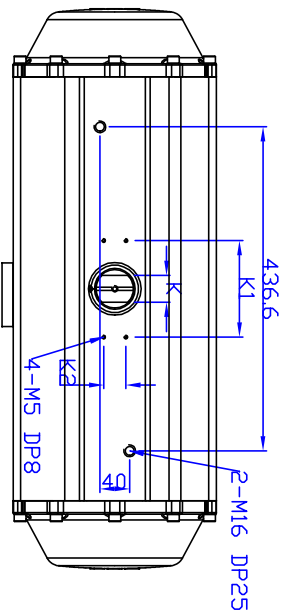
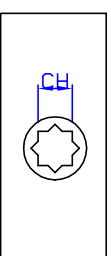
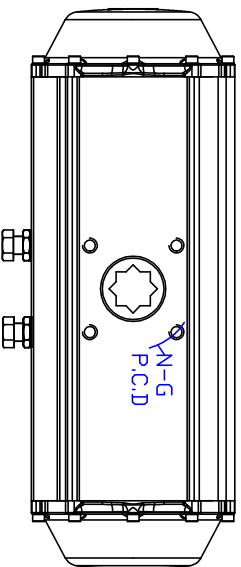

■ DIMENSION(mm)

MODEL	K1	K2	ISO	φP.C.D	N-G(DP)	K	L	T	T1	H	H1	CH	DP	WEIGHT
AD250	130	30	F16	165	4-M20 (29)	36	755	301	152	335	305	46*46	60	65.8kg

REV.NO.	REVISION DESCRIPTION	DRAWN / DATE	REVIEWED / DATE	APPROVED / DATE
△	바디 형상변경	노윤아 / 171012		
△	바디 형상변경	노윤아 / 171109		

Operating

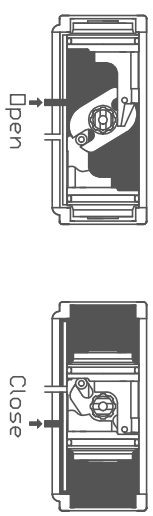

MAJOR PART LIST

NO.	PART NAME	MATERIAL
1	BODY	ALUMINUM
2	SHAFT	STEEL ALLOY (NICKEL COATING)
3	SHAFT ROLLER	ENGINEERING PLASTIC
4	CRANK	STEEL ALLOY
5	PISTON	ALUMINUM
6	COVER	ALUMINUM

SPECIFICATIONS

1. Operating fluid : Compressed dry air
2. Operating pressure : 4Bar~7Bar
3. Operating temperature : -20~80°

PRODUCT NAME Pneumatic actuator		TITLE DRAWING	
MODEL A250	HARDNESS -	DRAWING NO. PAAD250-001	
DRAWING DATE	APPROVED DATE	REV. 6	

KOSAPLUS Co.,Ltd

DRAWING