

SCOTCH-YOKE / SPRING RETURN / AS65

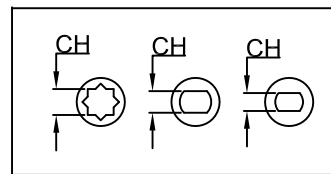

REV.NO.	REVISION DESCRIPTION	DRAWN / DATE	REVIEWED / DATE	APPROVED / DATE
△	바닥 ISO 탭 깊이치수 추가	노을아/120727		
△	바닥 ISO 탭 깊이치수 수정	노을아/130619		

Operating

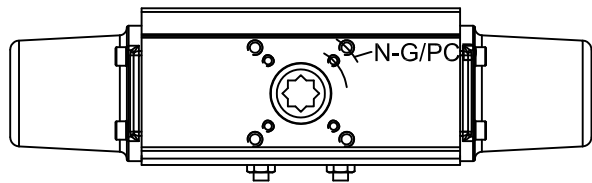
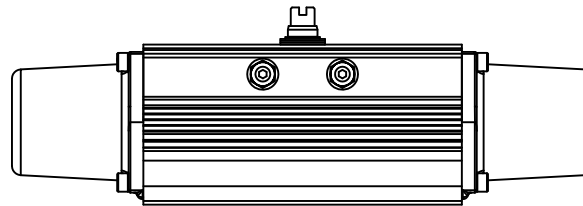
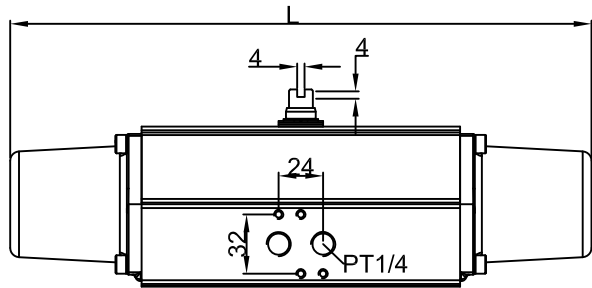
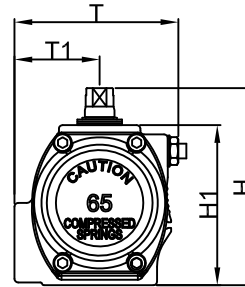
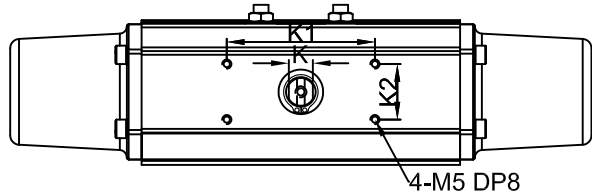
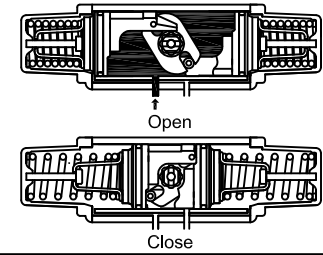

MAJOR PART LIST

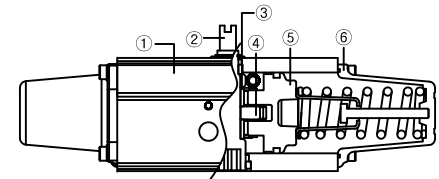

NO.	PART NAME	MATERIAL
1	BODY	ALUMINUM
2	SHAFT	STEEL ALLOY (NICKEL COATING)
3	SHAFT ROLLER	ENGINEERING PLASTIC
4	CRANK	STEEL ALLOY
5	PISTON	ALUMINUM
6	COVER	ALUMINUM

SPECIFICATIONS

- Operating fluid : Compressed dry air
- Operating pressure : 4Bar~7Bar
- Operating temperature : -20°~80°
- Spring torque : Weak (Middle) Strong

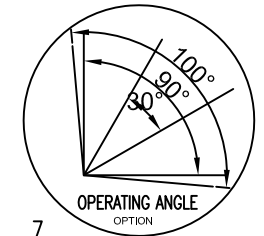
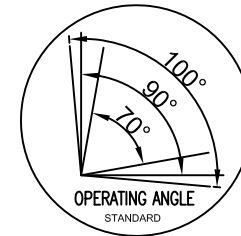

■ DIMENSION(mm)

MODEL	K1	K2	ISO	øP.C.D	N-G (DP)	K	L	T	T1	H	H1	CH	DP	WEIGHT
AS65	80	30	F05/F07	50/70	4-M6/M8 (14/14)	13	314	89	46	107	87	14*14	17	3.0kg
												11.7*ø17	17	
												9.7*ø15	14	

■ Torque (Nm) at 4.5Bar

	0°	45°	90°
Open	54.0	28.0	35.0
Close	35.0	23.0	54.0

PRODUCT NAME Pneumatic actuator		KOSAPLUS Co.,Ltd	
MODEL AS65	TITLE DRAWING		
MATERIAL -	HARDNESS -	DRAWING NO. PAAS65-001	REV. 6
DRAWING DATE	APPROVED DATE		