

SCOTCH-YOKE / SPRING RETURN / AS210

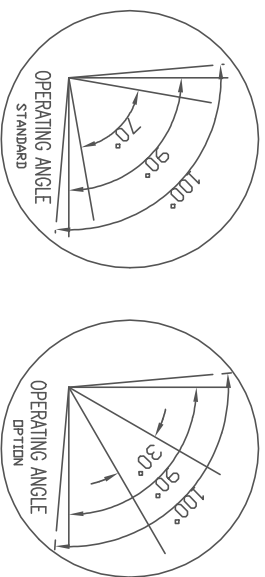

REV.NO.	REVISION DESCRIPTION	DRAWN / DATE	REVIEWED / DATE	APPROVED / DATE
△	바닥 ISO 타입 김이식수 추가	노윤아 / 120727		
△	토크수정 (스프링변)	노윤아 / 130619		

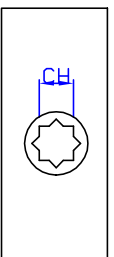
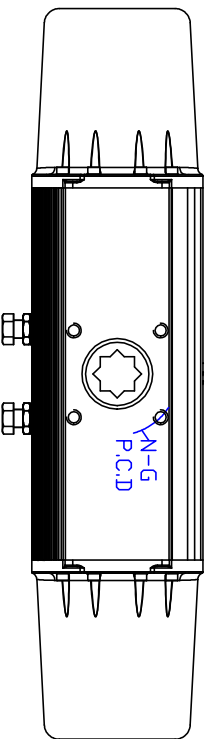
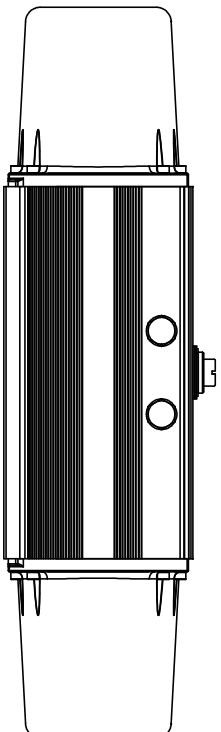
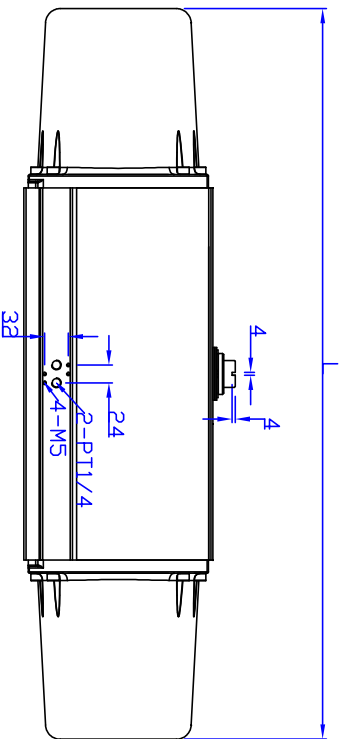
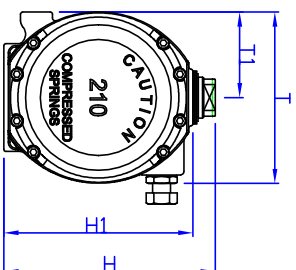
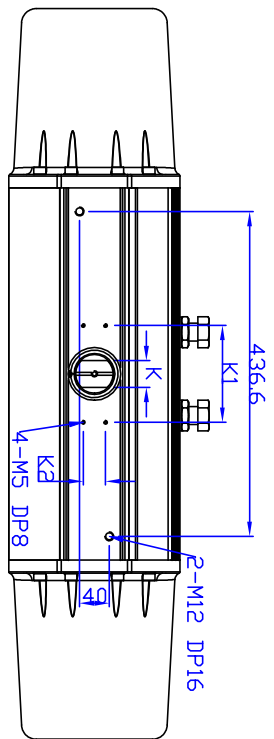
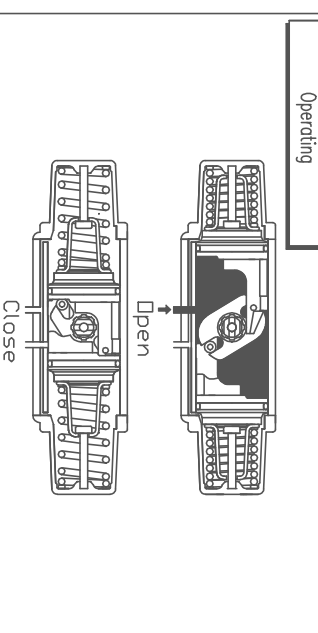

MAJOR PART LIST

NO.	PART NAME	MATERIAL
1	BODY	ALUMINIUM
2	SHAFT	STEEL ALLOY (NICKEL COATING)
3	SHAFT ROLLER	ENGINEERING PLASTIC
4	CRANK	STEEL ALLOY
5	PISTON	ALUMINIUM
6	COVER	ALUMINIUM

SPECIFICATIONS

1. Operating fluid : Compressed dry air
2. Operating pressure : 4Bar~7Bar
3. Operating temperature : -20~80°
4. Spring torque : Weak/Middle/Strong

DIMENSION(mm)			Torque (Nm) at 6Bar															
MODEL	K1	K2	ISO	φP.C.D	N-G(DP)	K	L	T	T1	H	H1	CH	DP	WEIGHT	Open	45°	90°	
AS210	130	30	F16	165	4-M20 (30)	36	982	231	115	284	254	46*46	60	77.2kg	Close	1750.0	1040.0	2140.0

PRODUCT NAME		TITLE	
Pneumatic actuator		KOSAPLUS Co.,Ltd	
MODEL	AS210	DRAWING	
MATERIAL	-	DRAWING NO.	PAAS210-001
HARDNESS	-	DATE	REV. 5