

SCOTCH-YOKE / DOUBLE ACTING / AD185

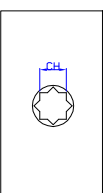

REV.NO.	REVISION DESCRIPTION	DRAWN / DATE	REVIEWED / DATE	APPROVED / DATE
△	K, K1 수정, H 오류 수정	노윤아 / 171012		
△	L,DP,WT 수정	노윤아 / 190923		

Operating

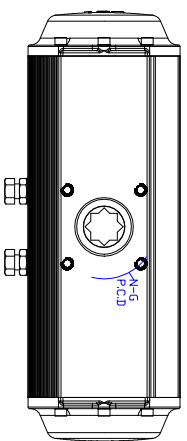
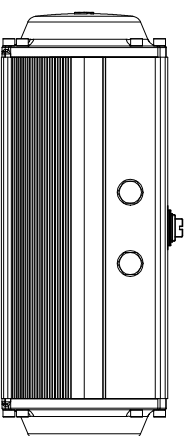
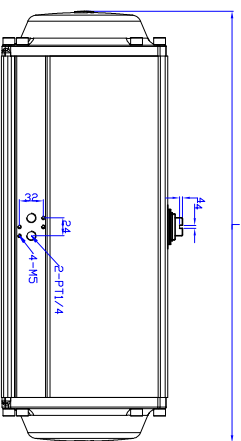
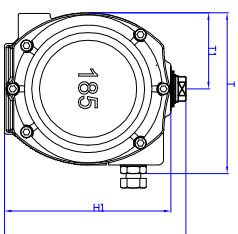
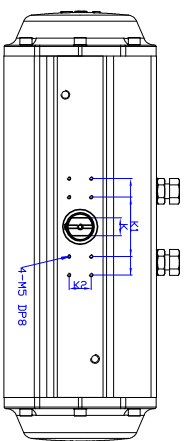
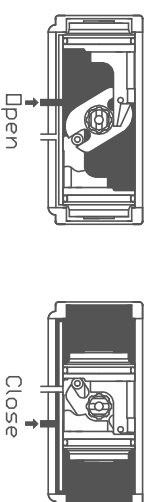

MAJOR PART LIST

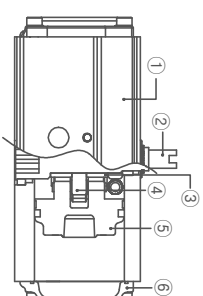

NO.	PART NAME	MATERIAL
1	BODY	ALUMINUM
2	SHAFT	STEEL ALLOY (NICKEL COATING)
3	SHAFT ROLLER	ENGINEERING PLASTIC
4	CRANK	STEEL ALLOY
5	PISTON	ALUMINUM
6	COVER	ALUMINUM

SPECIFICATIONS

1. Operating fluid : Compressed dry air
2. Operating pressure : 4Bar~7Bar
3. Operating temperature : -20~80°

■ DIMENSION(mm)

MODEL	K1	K2	ISO	ΦP.C.D	N-G(DP)	K	L	T	T1	H	H1	CH	DP	WEIGHT
AD185	130/80	30	F14	140	4-M16 (26)	24	581	217	103	244	224	36*36	38	34.8kg

PRODUCT NAME Pneumatic actuator		TITLE DRAWING	
MODEL AD185	HARDNESS -	DRAWING NO. PAAD185-001	
DRAWING DATE	APPROVED DATE	REV. 3	
KOSAPLUS Co.,Ltd			