

RACK&PINION / SPRING RETURN / RS210

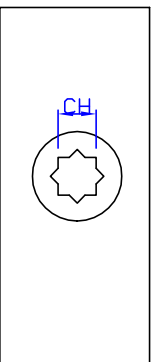
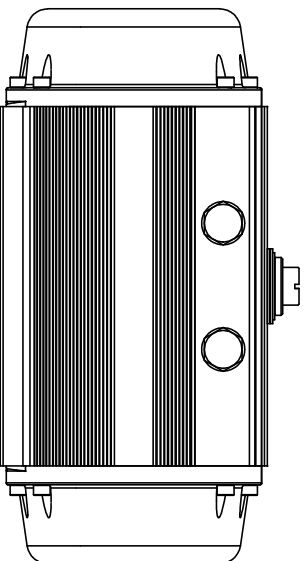
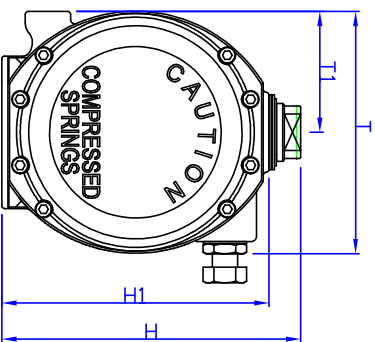
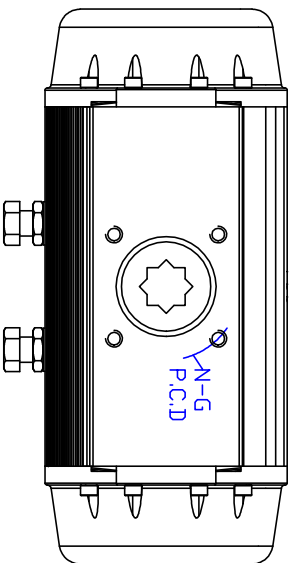
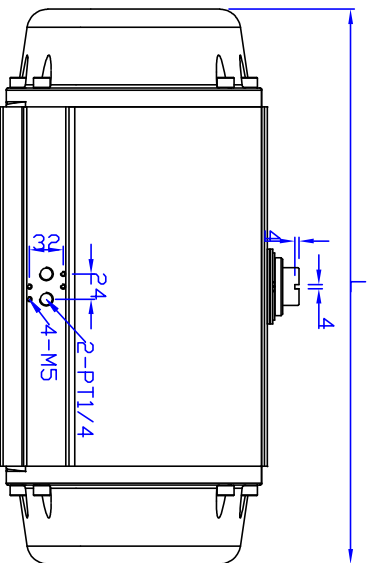
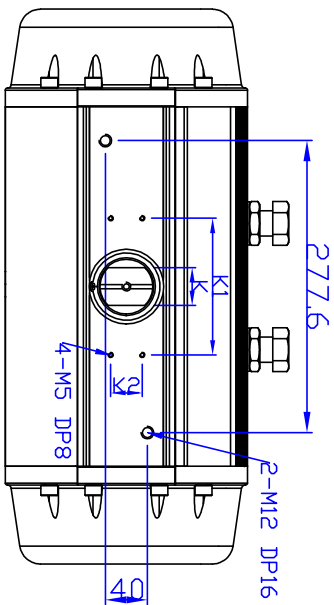

DIMENSION(mm)											
MODEL	K1	K2	ISO	ØP.C.D	N-G(DP)	K	L	T	T1	H	H1
RS210	130	30	F14	140	4-M16 (23)	36	527	231	115	284	254
CH	DP	WEIGHT									
36*36	30	37.9kg									

Torque (Nm) at 4.5Bar			
Open	Close (spring 8)	0°	90°
724.5	323.2		452.5
	565.0		

PRODUCT NAME Pneumatic actuator		TITLE DRAWING	
MODEL RS210	HARDNESS -	DRAWING NO. PARS210-001	REV. 5
KOSAPLUS Co.,Ltd			

REV.NO.	REVISION DESCRIPTION	DRAWN / DATE	REVIEWED / DATE	APPROVED / DATE
△	바닥 ISO 톨 가이드수 삽입	노윤아 / 120730		
△	바닥 ISO 톨 가이드수 수정	노윤아 / 130619		

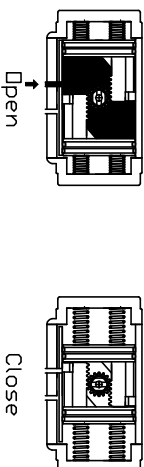

MAJOR PART LIST

NO.	PART NAME	MATERIAL
1	BODY	ALUMINIUM
2	SHAFT	STEEL ALLOY (NICKEL COATING)
3	PISTON	ALUMINIUM
4	COVER	ALUMINIUM

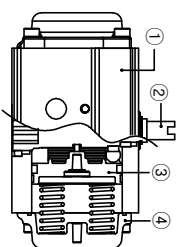

SPECIFICATIONS

1. Operating fluid : Compressed dry air
2. Operating pressure : 4Bar~7Bar
3. Operating temperature : -20~80°

