

SCOTCH-YOKE / SPRING RETURN / ASS50

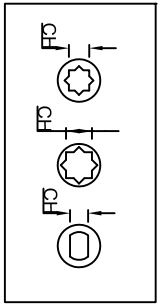

REV. NO.	REVISION DESCRIPTION	DRAWN / DATE	REVIEWED / DATE	APPROVED / DATE
△	바닥 ISO 및 김이셔수 수정	노용아 / 130619		
△	포그새제	노용아 / 191115		

Operating

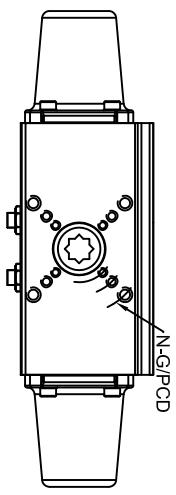
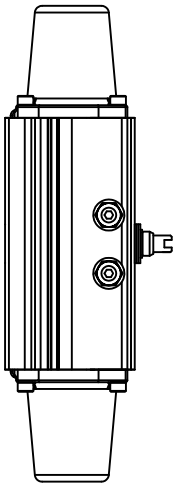
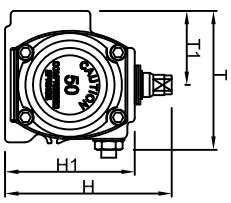
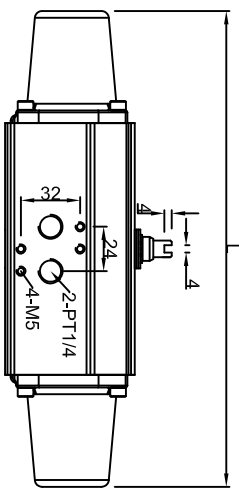
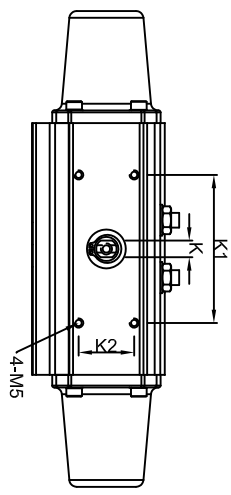
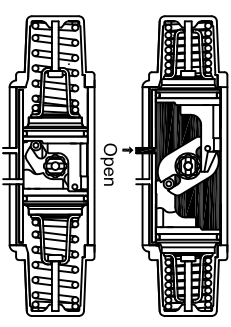

MAJOR PART LIST

NO.	PART NAME	MATERIAL
1	BODY	ALUMINIUM
2	SHAFT	STEEL ALLOY (NICKEL COATING)
3	SHAFT ROLLER	ENGINEERING PLASTIC
4	CRANK	STEEL ALLOY
5	PISTON	ALUMINIUM
6	COVER	ALUMINIUM

SPECIFICATIONS

- Operating fluid : Compressed dry air
- Operating pressure : 4Bar~7Bar
- Operating temperature : -20~-80°
- Spring torque : Weak $\frac{1}{10}$ Strong

PRODUCT NAME	Pneumatic actuator	TITLE	KOSAPLUS Co.,Ltd
MODEL	ASS50	DRAWING NO.	PAAS50-001
MATERIAL		HARDNESS	
DRAWING DATE		APPROVED DATE	

REV.	5
------	---

MODEL	K1	K2	ISO	ØP.C.D	N-G (DP)	K	L	T	T1	H	H1	CH	DP	WEIGHT
AD50	80	30	F03/F05/F07	35/50/70	4-M5/M6/M8 (10/12/12.5)	9	257	75	40	90	70	11*11 14*14	13 14	1.6kg

DIMENSION(mm)														
MODEL	K1	K2	ISO	ØP.C.D	N-G (DP)	K	L	T	T1	H	H1	CH	DP	WEIGHT
AD50	80	30	F03/F05/F07	35/50/70	4-M5/M6/M8 (10/12/12.5)	9	257	75	40	90	70	11*11 14*14	13 14	1.6kg